

NOTE:
 CEILING TO BE INSTALLED AT A HEIGHT ACC. TO SOR (MIN. 2300 AB. FLOOR), GIVEN DIMENSIONS ARE FOR GUIDANCE ONLY.
 PIPES MAY PROTRUDE INTO ACCOMMODATION, YARD TO MAKE LOCAL ENCLOSURE, IF NECESSARY.

205	2	SINK (HDPE)	Btl. 700x600
204	ARR	W/MANIFOLD DESK	Depth: 500 H: 900

202	4	SHELF CABINET	
201	4	CHAIR	
200	4	DRAWERS	

REV.	DESCRIPTION	DATE	BY	CHKD.
A	REVISION ACC. TO MISC COMMENTS	11.01.06	STG	
B	REVISION ACC. TO MISC COMMENTS	20.02.06	STG	
C	EL. CABINETS ADDED	25.04.06	STG	
D	AS-BUILT	17.06.06	FS	

DATE: 09.05.05
 SCALE: 1:25

PROJECT NO.: 2003077

ARR. IN CHEMISTRY LAB., UPPER DECK

SKIPSTJEKNISK AS
 CONSULTING NAVAL ARCHITECTS AND MARINE ENGINEERS
 Telefon: 47 70 10 33 44, Telefax: 47 70 10 33 48
 E-mail: office@skipsteknisk.no

185-510-032-D

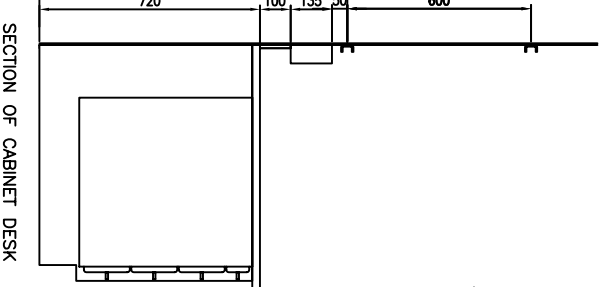

ALL STAFFE RAILS ON WALL TO BE MOUNTED NOT MORE THAN 200mm FROM WALL OR CORNER